

iDC-14H-I-JF-



PULLEY PITCH DIAMETER	89.13mm (3.509")
PULLEY WIDTH	55mm (2.160")
PULLEY MATERIAL	STEEL
BELT WEIGHT (kg)	$((\text{TRAVEL IN METERS} \times 2) + 1.70) \times .34$
TRAVEL PER REV.	280mm
TRAVEL MIN.	150mm
TRAVEL MAX.	5675mm
CART WEIGHT (kg)	5.44 PER CART
SYSTEM WEIGHT (kg)	$(\text{TRAVEL IN METERS} \times 12.2) + 26.7$

ENTER
TRAVEL IN INCREMENTS OF 25mm

SELECT
DRIVE SHAFT LOCATION*

SHAFTING TYPE
A0= SINGLE SHAFTED
B0= DOUBLE SHAFTED

NOTE: (IF "B" IS USED THE NUMBER WILL
DESIGNATE POSITION OF MOUNTING FLANGE.)
AM= SINGLE SHAFTED W/ MOTOR MOUNT
BM= DOUBLE SHAFTED W/ MOTOR MOUNT

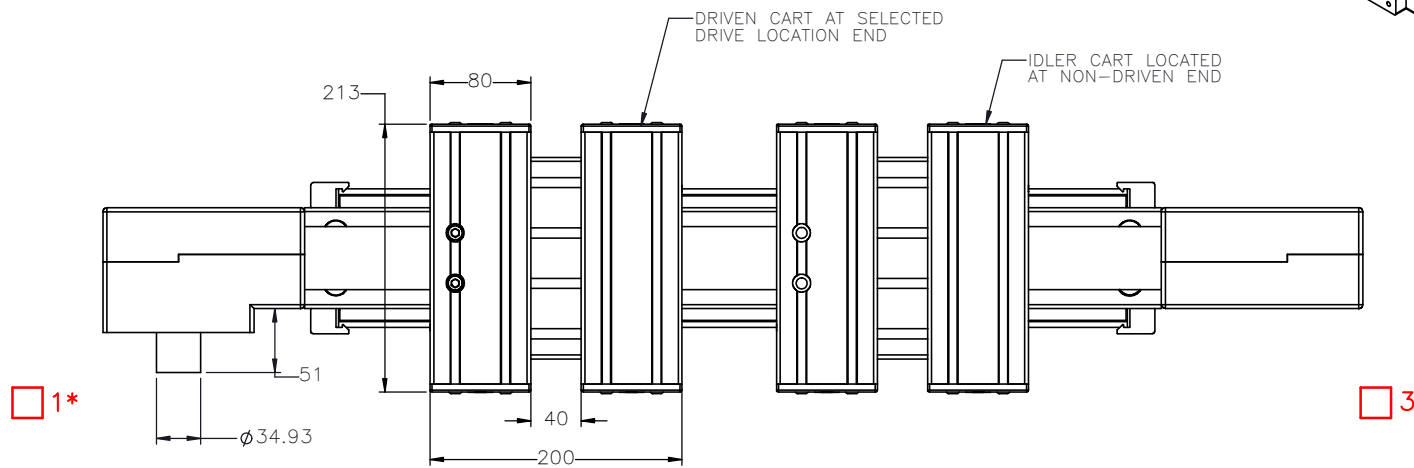
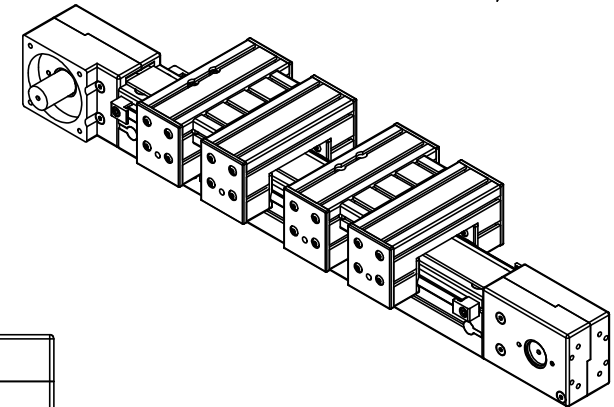

3*

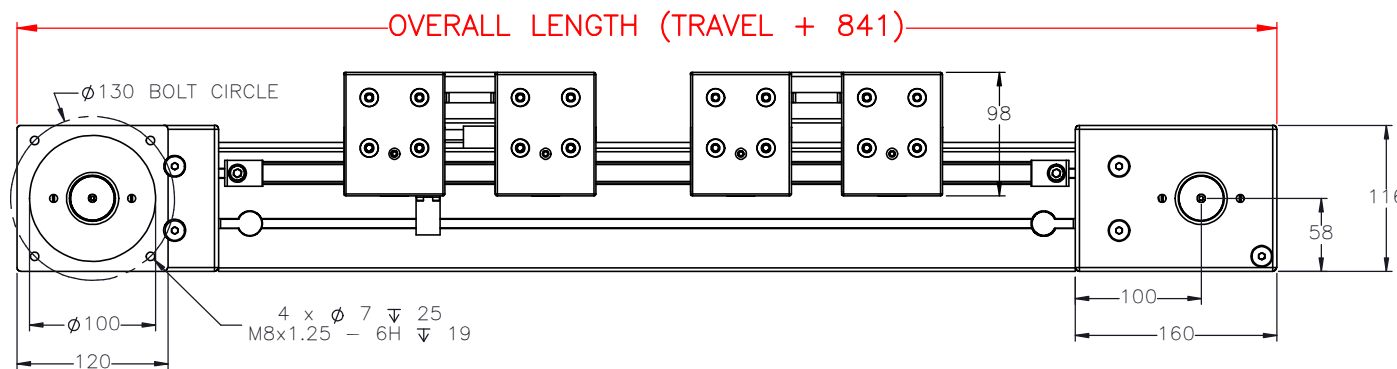

4 x $\phi 7 \nabla 22$
M8x1.25 - 6H $\nabla 19$

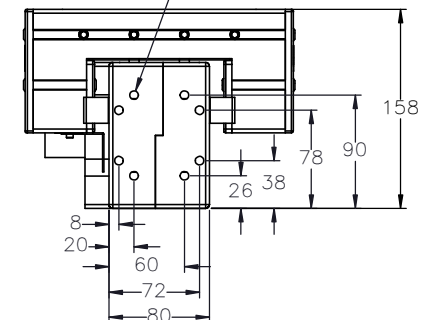

APPROVED: _____

DATE: _____



DRAWN BY: —	DATE: DD/MM/YYYY	MATERIAL:	TITLE:
CHECKED BY: —	DATE: DD/MM/YYYY	FINISH:	IPS 14H DUAL CART ACTUATOR
LAST SAVED BY: —	DATE: DD/MM/YYYY	SCALE: 1:1	SHEET SIZE: C
UNLESS OTHERWISE SPECIFIED, DIMENSIONS ARE IN INCHES. TOLERANCES UNLESS NOTED OTHERWISE: .X ± .03 .XX ± .010 .XXX ± .005 ANG ± 0°30'		SHEET: 1 OF 2	REV: C
SURFACE FINISH: BREAK ALL SHARP EDGES DIMENSIONAL LIMITS APPLY AFTER FINISHING THIRD ANGLE PROJECTION		PART NUMBER: iDC-14H	

SPECIFICATIONS ARE SUBJECT
TO CHANGE WITHOUT NOTICE

CART MOUNTING
T-SLOT FEATURES

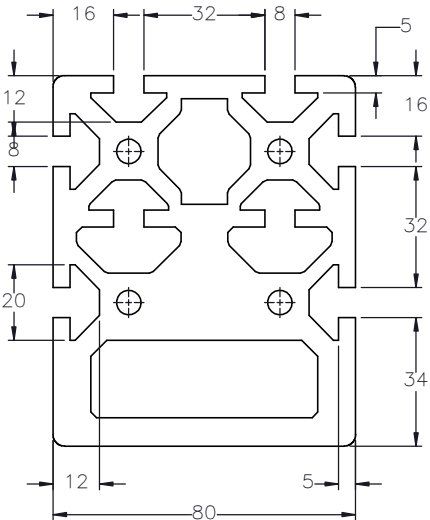
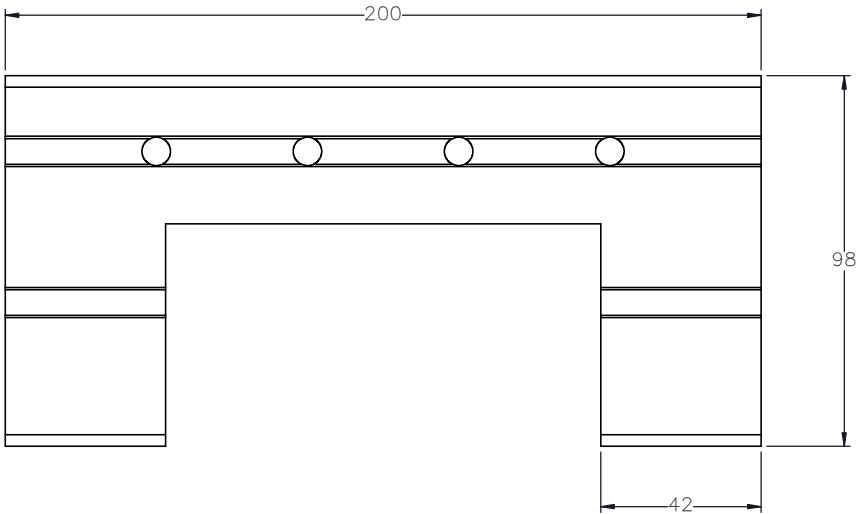

ACTUATOR BODY
T-SLOT MOUNTING
FEATURES

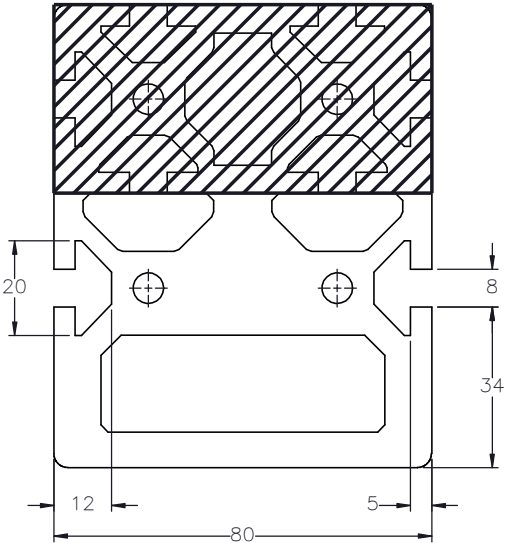

CART EXTENDER
T-SLOT FEATURES

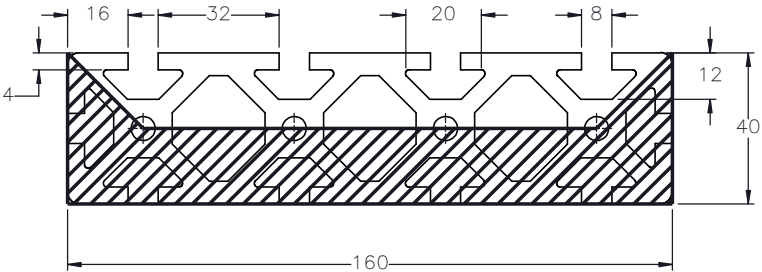

DRAWN BY: — DATE: DD/MM/YYYY
CHECKED BY: — DATE: DD/MM/YYYY
LAST SAVED BY: — DATE: DD/MM/YYYY

MATERIAL: —
FINISH: —

TITLE: CART MOUNTING FEATURES
SCALE: 1:1 SHEET SIZE: C

THIS DRAWING IS THE PROPERTY OF IPS. ANY REPRODUCTIONS SHALL BE FOR QUOTATION, MANUFACTURING, OR PURCHASING PURPOSES ONLY. RELEASE OF DRAWINGS TO OTHER CONCERNS DOES NOT CONSTITUTE LICENSING IN ANY WAY. INFORMATION CONTAINED HEREIN IS PROPRIETARY AND CONFIDENTIAL.

SURFACE FINISH: ☒ BREAK ALL SHARP EDGES
DIMENSIONAL LIMITS APPLY AFTER FINISHING
THIRD ANGLE PROJECTION

SHEET: 2 OF 2
PART NUMBER: —

REV: —
ISA-14H

SPECIFICATIONS ARE SUBJECT TO CHANGE WITHOUT NOTICE